

### D-Series Size 2 LED Area Luminaire

**Specifications**

EPA: 1.56 (3.18 m²)  
Length: 40.59" (1031 mm)  
Width: 16.76" (425 mm)  
Height H1: 8.11" (206 mm)  
Height H2: 3.96" (100 mm)  
Weight: 46 lbs (20 kg)

**Ordering Information**

EXAMPLE: DSX2 LED P7 40K 70CRI TSM MVOLT SPA NLTAIR2 PIRHN DDBXD

Series	LEDs	Color temperature*	Color Rendering Index*	Distribution	Beam Type	Voltage	Mounting
DSX2 LED	Forward optics	(this section 70CRI only)	70CRI	AFR	Automotive front view	TSM	Type II medium
	P1	P5	30K 3000K	T15	Type I short	T5G	Type I low glare
	P2	P6	40K 4000K	T2M	Type I medium	T5M	Type I wide
	P7	P7	50K 5000K	T3M	Type I medium	BLCA	Type II backlight control
DSX2 LED	Recessed optics	(this section 80CRI only, extended lead times apply)	80CRI	T4M	Type I medium	BLCA	Type II backlight control
	P10	P11	27K 2700K	T4G	Type I low glare	LECD	Left corner control
	P11	P14	30K 3000K	T5M	Type I medium	RECD	Right corner control
	P12	P14	35K 3500K	T5M	Type I medium	RECD	Right corner control

Control options	Other options	Finish options
<b>Shipped installed</b> NLTAIR2 PIRHN	<b>Shipped installed</b> SP1200P	<b>Shipped installed</b> DDBXD
Single AIG pins (2 included with the luminaire) / ambient sensor, 8-40' mounting height, ambient sensor enabled at 26' +/-	FAO Field adjustable output +/-	Dark Bronze
High flow, medium/ambient sensor (8-40' mounting height, ambient sensor enabled at 26' +/-)	BLCA Backlight control	Black
High flow, medium/ambient sensor (8-40' mounting height, ambient sensor enabled at 26' +/-)	LECD Left corner control	Natural Aluminum
High flow, medium/ambient sensor (8-40' mounting height, ambient sensor enabled at 26' +/-)	RECD Right corner control	White
High flow, medium/ambient sensor (8-40' mounting height, ambient sensor enabled at 26' +/-)	CE Central Control	Forward black
High flow, medium/ambient sensor (8-40' mounting height, ambient sensor enabled at 26' +/-)	HA 50' Ambient operation	Forward black
High flow, medium/ambient sensor (8-40' mounting height, ambient sensor enabled at 26' +/-)	Shipped separately	Forward white
High flow, medium/ambient sensor (8-40' mounting height, ambient sensor enabled at 26' +/-)	LECD	Forward white
High flow, medium/ambient sensor (8-40' mounting height, ambient sensor enabled at 26' +/-)	RECD	Forward white

**Shipped separately**  
LECD  
RECD

**Shipped separately**  
LECD  
RECD

**Shipped separately**  
LECD  
RECD

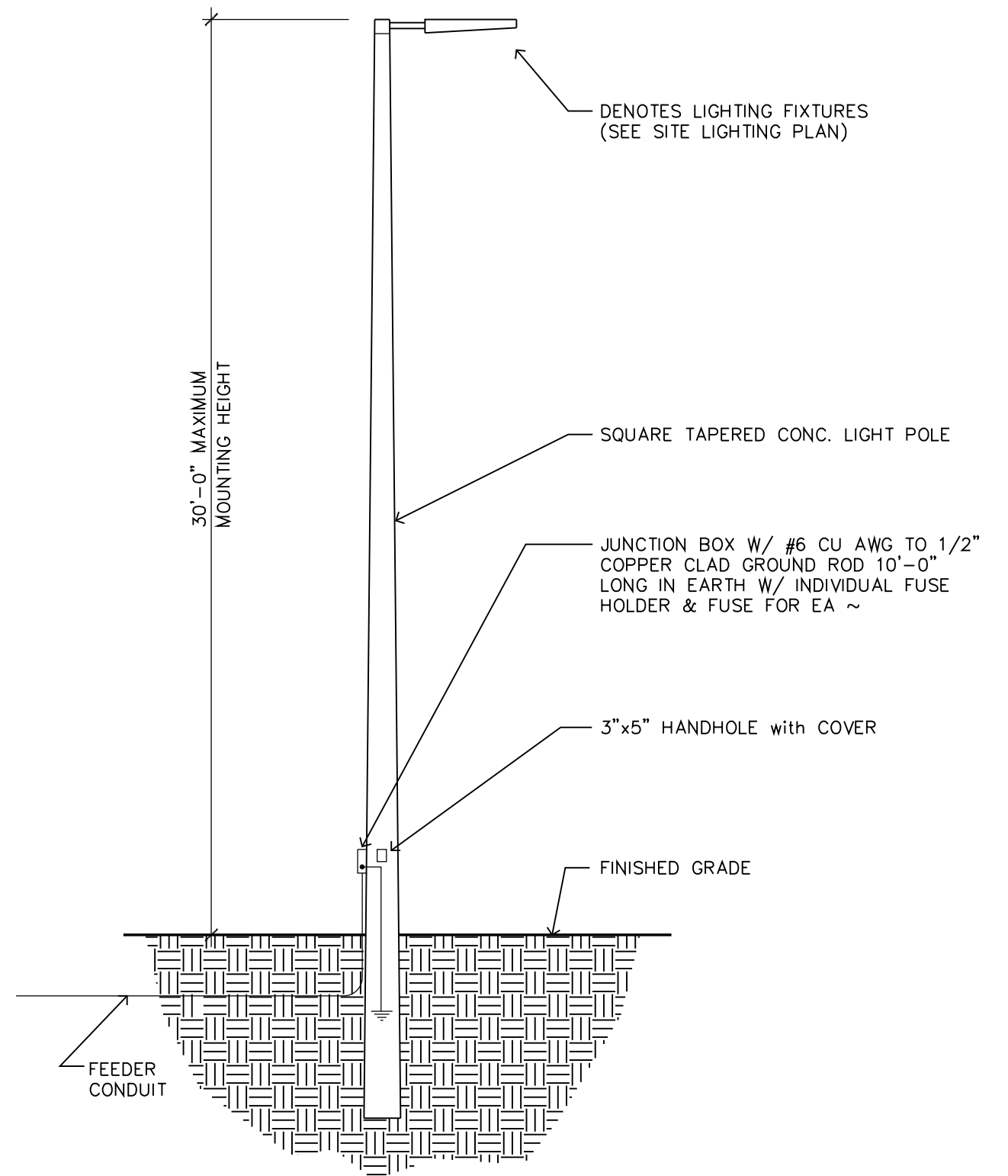

SUPPLIER OF POLES SHALL SUBMIT ENGINEERED SHOP DRAWINGS SIGNED & SEALED BY A REGISTERED PROFESSIONAL ENGINEER SIZED FOR THE EFFECTIVE PROJECTED AREA (EPA) OF THE LIGHT FIXTURES ULTIMATELY INSTALLED AND SHALL DETERMINE THE REQUIRED POLE EMBEDMENT DEPTH FOR THE CODE REQUIRED WIND VELOCITY PRESSURE

## 4 SPEC SHEET

### MUNICIPALITY REQUIREMENTS:

CONTRACTOR SHALL OBTAIN LATEST COPY OF REQUIREMENTS FROM THE MUNICIPALITY



MINIMUM FC = 1.0  
MAX POLE HEIGHT = 30'  
MAXIMUM SPLIAGE = 3.0 FC AT 5 FEET AGL  
LUMINAIRE TYPE = FULL CUTOFF

NO SHADE TREE WITHIN 15 FEET OF LUMINAIRE

LIGHT LOSS FACTOR = 0.9  
MAX TO MIN RATIO = 12:1  
LUMINAIRE TYPE = LED

NOTE: THE SITE PHOTOMETRIC DRAWING WAS DESIGNED UTILIZING THE SPECIFIED LUMINAIRE MANUFACTURER. ANY DEVIATION FROM THE DESIGN DRAWING SHALL REQUIRE PLAN REVISIONS TO THE PERMITTING AGENCIES.

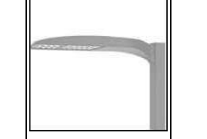
Luminaire Locations									
Location					Aim		Aim		
No.	Label	X	Y	Z	MH	X	Orientation	Tilt	Y
3	A	-1331.00	1529.00	30.00	30.00	-1329.42	102.99	0.00	1528.64
1	B	-1233.00	1636.00	30.00	30.00	-1234.35	303.69	0.00	1636.90
2	B	-1275.00	1686.00	30.00	30.00	-1273.70	126.87	0.00	1685.03
2	A	-1314.15	1600.53	30.00	30.00	-1312.57	102.99	0.00	1600.17

Schedule									
Symbol	Label	Image	QTY	Manufacturer	Catalog	Description	Number Lamps	Lamp Output	LF
	A		2	Lithonia Lighting	DSX2 LED P5 50K 70CRI T5M	D-Series Size 2 Area Luminaire P5 Performance Package 5000K CCT 70 CRI Forward Throw	1	41869	0.9
	B		2	Lithonia Lighting	DSX2 LED P4 50K 80CRI TSM	D-Series Size 2 Area Luminaire P4 Performance Package 5000K CCT 80 CRI Type 5 Medium	1	33736	0.9

## 3 LIGHT FIXTURE SCHEDULE

## 2 LIGHT POLE DETAIL

SCALE 1/4" = 1'-0"

## 1

## PARTIAL SITE LIGHTING PHOTOMETRIC PLAN AT NEW ENTRANCE AND TURN LANE

SCALE 1/8" = 1'-0"

FOR FURTHER INFORMATION, SEE PLANS BY WINNINGHAM & FRADLEY, ENGINEERS AND MCLAGHLIN ENGINEERING FOR SURVEY.

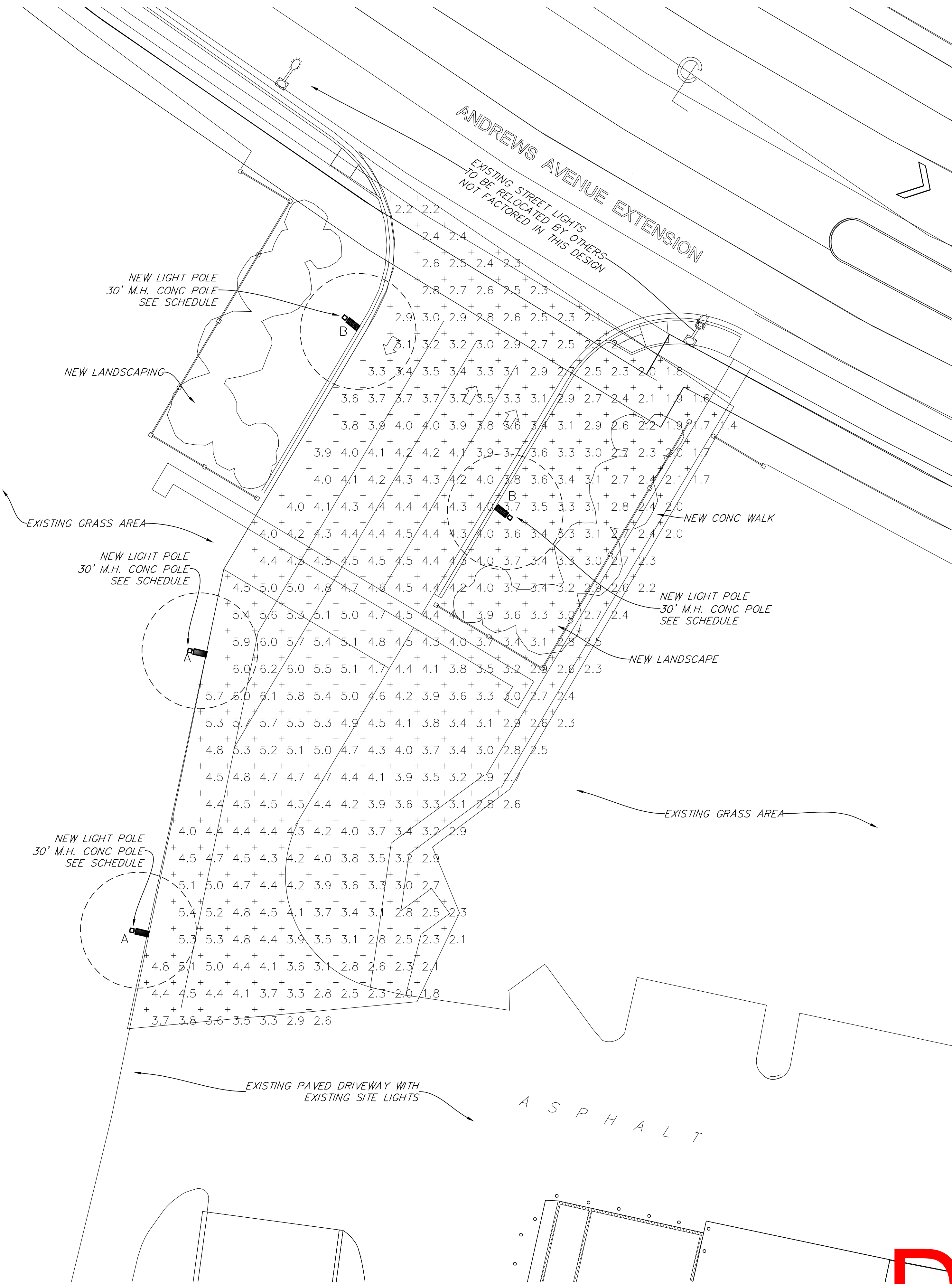

AA26001731

WILLIAM J. GALLO FL AR0008440

**Brian Herbert**  
Digitally signed by Brian Herbert  
Date: 2023.07.20 10:40:32 -04'00'

BRIAN P. HERBERT FL AR0015474

## BONSAL TURN LANE

1200 NW 18TH ST  
POMPANO BEACH FL 33069

OWNER

OLDCASTLE APG

REVISIONS

No.	Description	Date
1	MINOR SITE SBMTL	07-19-2023

PROJECT STATUS

MINOR SITE PLAN SUBMITTAL

DATE

JULY 20, 2023

PROJECT NUMBER

2123

SCALE

AS SHOWN

DRAWN BY

CHECKED BY

JET

DRAWN BY

CHECKED BY

JET

SITE LIGHTING PHOTOMETRIC PLAN

DRAWN BY

CHECKED BY

JET

**DRC**  
23-120003-2  
10/04/2023